



Premier Steel Gutter System™
- the STEEL rainwater system



www.advarchsm.com

Solutions that enhance the overall result



Fascia Hanger, Adjustable
This hanger can be adjusted to match any roof pitch. Strong, yet extremely easy to fit.



Flat End Cap with Rubber Seal
These end caps are self-sealing with an EPDM tube. They are fully reversible, i.e. same unit fits on both left and right end of a gutter. And they are easily mounted with just a single, firm knock.



Gutter Connector with Rubber Seal
The gutter connector is easy to fit and allows the joining of two sections of gutter without the need to use a silicon calking adhesive. Simply leave a 1/8" -1/4" gap between the two sections of gutter to be joined and connect using our easy to install gutter connector. The result is a very firm and durable connection. The EDPM seal is long lasting and guaranteed leak proof.



Plug-In Outlet
This versatile outlet has a one-grip, snap-on mounting that ensures a perfect fit to the semi-circular shape of the gutter. Can be mounted after the gutter is in place.

Traditional methods can also be used to install our gutter

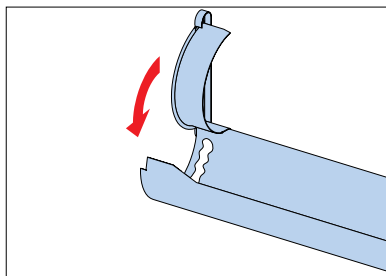
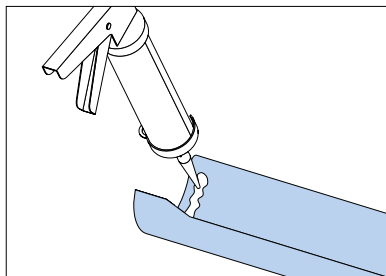

Flat End Cap
Traditional type end caps also available. Use a silicon calking adhesive.

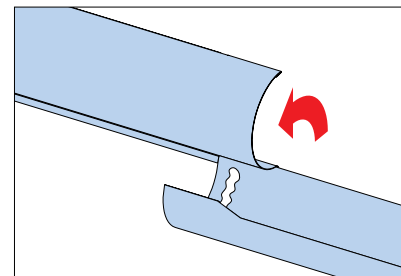
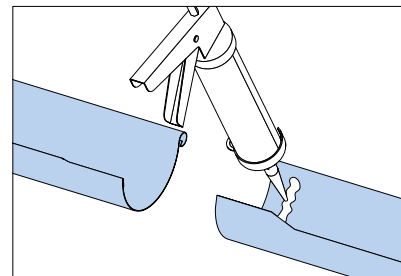

Gutter Connection
Sections of gutter can also be joined by using a silicon calking adhesive. The gutter should then overlap and be sealed with silicon.

TECHNICAL INFORMATION

Prelaq Nova HBP Polyester

1. Steel sheet
2. Zinc coating
3. Pretreatment layer
4. Primer layer
5. Paint layer

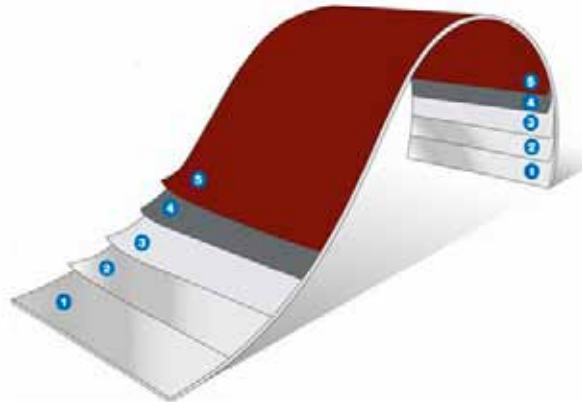

Prelaq Nova is a special, extra-thick variant of polyester coating. It has a wear-resistant, textured surface, achieved by polymer grains being mixed into the paint. It also has better forming properties than ordinary polyester.

Zinc coating

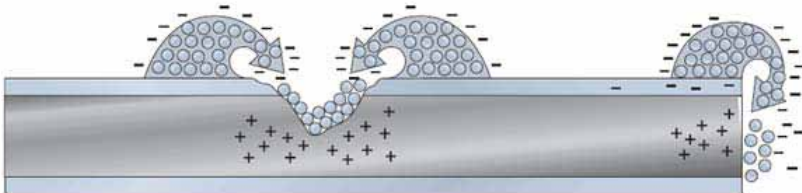

The Zinc coating provides the sheet steel with double protection against corrosion.

It serves as an effective barrier that excludes oxygen and moisture, and it provides cathodic protection at cut edges and at any point where Zinc coating has been damaged.

If the sheet has been exposed to moisture, a galvanic coupling will be formed, in which the steel is the cathode. The anode (Zinc) "sacrifices itself" and in the process, forms a protective barrier that effectively prevents any further corrosion of the steel.

*The amount of Zinc is 0.90oz./ft² (both sides)

Extra durable high build polyester paint finishes

White (WT)		
Black (BK)		
Silver Metallic (SM)		
Brown (BN)		
Dark Gray (GY)		
Copper Metallic (CM)		
Tile Red (TR)		
Dark Red (RD)		
Anthract Metallic (AM)		
Pine Green (GN)		

= special order

The Complete System

– Prepainted 24 Gauge Galvanized G90

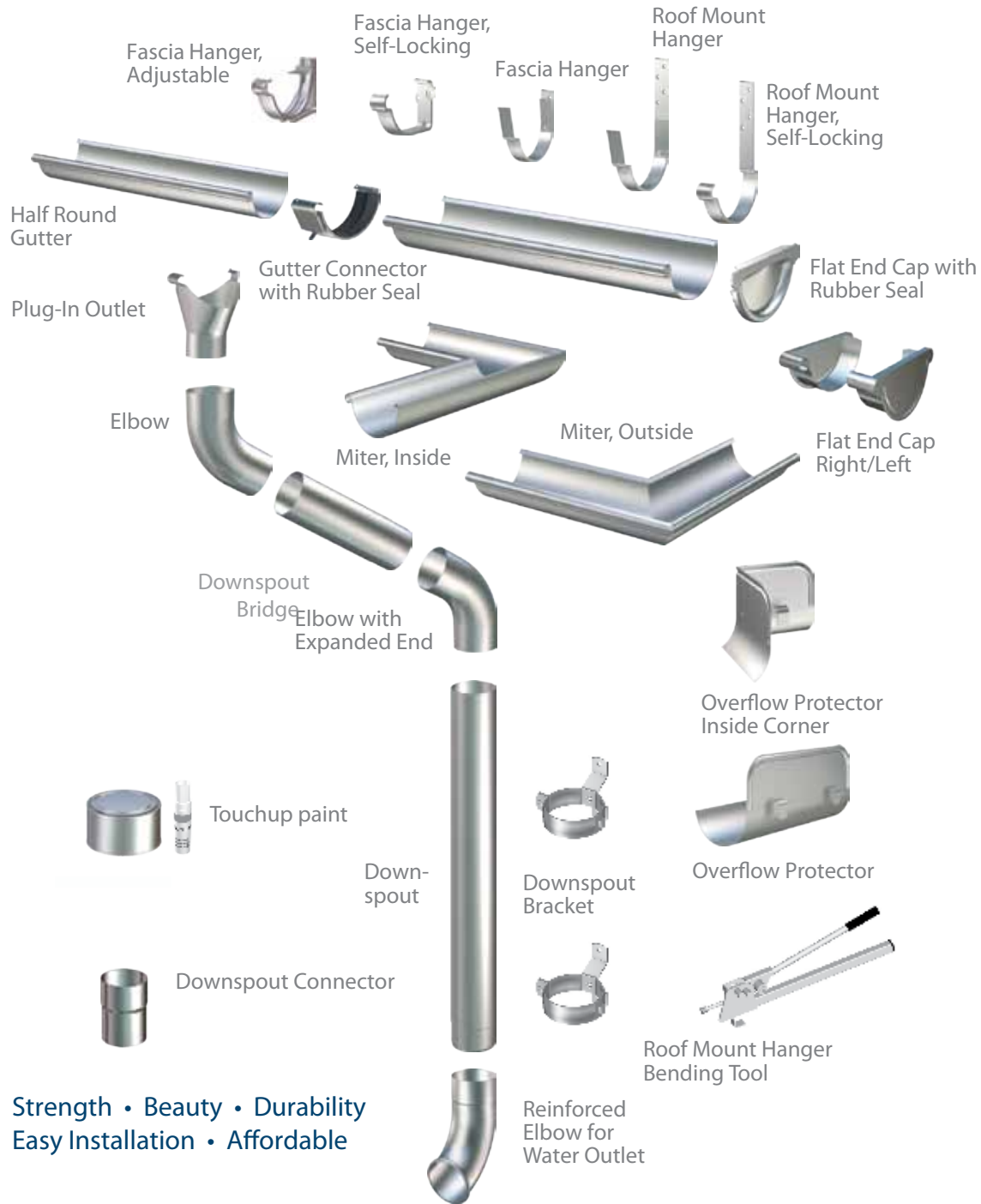

Strength • Beauty • Durability
 Easy Installation • Affordable



Also available in 16oz. 18oz. & 20oz.. Copper and 20oz. Zinc.

Advanced Architectural Sheet Metal
 108 East 22nd Street, Chicago Heights, IL 60411
 708-756-4890 or (877) 756-4890 Toll Free in U.S. only-Fax: 708-756-4892
 Email Us: harry@advarchsm.com | www.advarchsm.com